

テクニカルデータ

穴加工寸法

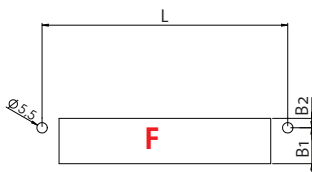
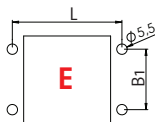
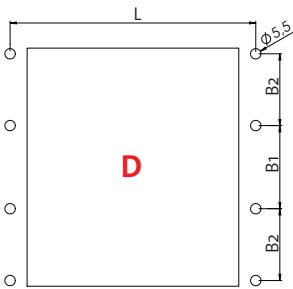
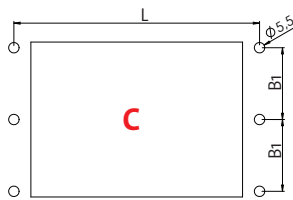
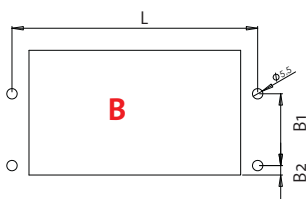
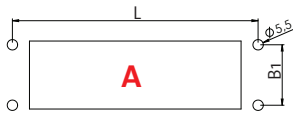

| 型式 | ページ | 穴あけ タイプ | 加工寸法 [mm] | | | 取り付け穴 h × l [mm] |
|---|--|------------|--|----|----|---|
| | | | L | B1 | B2 | |
| KEL(-U/-ER) 24 x KEL-FG A KEL-QUICK 24 10 KEL-BES(-S) 24 KEL-DPZ 24 x KEL-DPU 24 x | 8 - 9 28 60 74 - 75 84 - 85 82 - 83 | A | 130 | 32 | - | 112 × 36 |
| KEL-SNAP 24 | 31 | A | 130 | 32 | - | max. 112 × 46 |
| KEL(-U/-ER) 16 x KEL-QUICK 16 8 KEL-BES(-S) 16 KEL-DPZ 16 | 10 - 11 60 74 - 75 86 | A | 103 | 32 | - | 86 × 36 |
| KEL-SNAP 16 | 31 | A | 103 | 32 | - | max. 86 × 46 |
| KEL(-U/-ER) 10 x KEL-QUICK 10 6 KEL-SNAP 10 KEL-BES(-S) 10 | 12 - 13 60 31 74 - 75 | A | 83 | 32 | - | 65 × 36 |
| KEL-DPZ 6 | 87 | A | 70 | 32 | - | 52 × 36 |
| KEL 24 x-E KEL 16 x-E | 22 25 | B | 130 103 | 38 | 5 | 112 × 66 86 × 66 |
| KEL 24 x-MT KEL 16 x-MT | 23 26 | C | 130 103 | 38 | - | 112 × 82 86 × 82 |
| KEL 24 x-2MT KEL 16 x-2MT | 24 27 | D | 130 103 | 44 | 38 | 112 × 126 86 × 126 |
| KEL(-U/-ER)-B KEL-DPZ-B | 14 - 15 88 | E | 58 | 32 | - | 46 × 46 |
| KEL-SNAP-B | 31 | E | 56 | 32 | - | 38 × 46 |
| KEL-FG B KEL-QUICK-B4 | 29 60 | E | 62.5 58 | 32 | - | 36 × 46 |
| KEL(-ER)-E x KEL-QUICK-E KEL-FL x | 16 - 17 61 32 | F | E2: 58 E3: 83 E4: 103 E5: 130 | 19 | 5 | E2: 43 × 24 E3: 65 × 24 E4: 86 × 24 E5: 112 × 24 |

テクニカルデータ

穴加工寸法

| 型式 | ページ | 穴あけタイプ | 加工寸法 [mm] | | | | 取り付け穴 h × l [mm] |
|----------------|-----|--------|-----------|-----|-------|-----|---------------------|
| | | | L1 | L2 | B1 | B2 | |
| KEL-DPZ-E | 89 | G | 130 | - | 9 | - | 112 × 18 |
| KEL-JUMBO 1 | 36 | H | 56.5 | - | 100.5 | - | 78 × 80.5 |
| KEL-JUMBO 2 | 36 | I | 147.5 | - | 100.5 | - | 168 × 80.5 |
| KEL 183 | 34 | J | 204 | 95 | 56 | 102 | 180 × 80 |
| KEL 183-E | 34 | N | 204 | 95 | 61 | 23 | 180 × 42 |
| KEL-JUMBO flex | 107 | K | 70 | - | 70 | - | ∅ 75.5 |
| KEL-ULTRA flex | 106 | L | ∅ 157 | - | - | - | ∅ 140 |
| KEL-DPZ-KL | 92 | M | 101 | 101 | 72 | 76 | 190 × 60 |

